

Installation Instructions Shutdown Kits for Deutz 912 Series Engines (F3L-6L)

The features of Trombetta's 3 wire solenoid are now available in kit form.
A PUSH solenoid simplifies the linkage usually required.
Results are ease of installation - shutdown reliability and low cost.

- **Reduce Cost**
- **Reduce Adjustments**
- **Reduce Coil Burnout**
- **Reduce Installation Time**
- **Eliminate Switch Problems**
- **Boost Reliability**

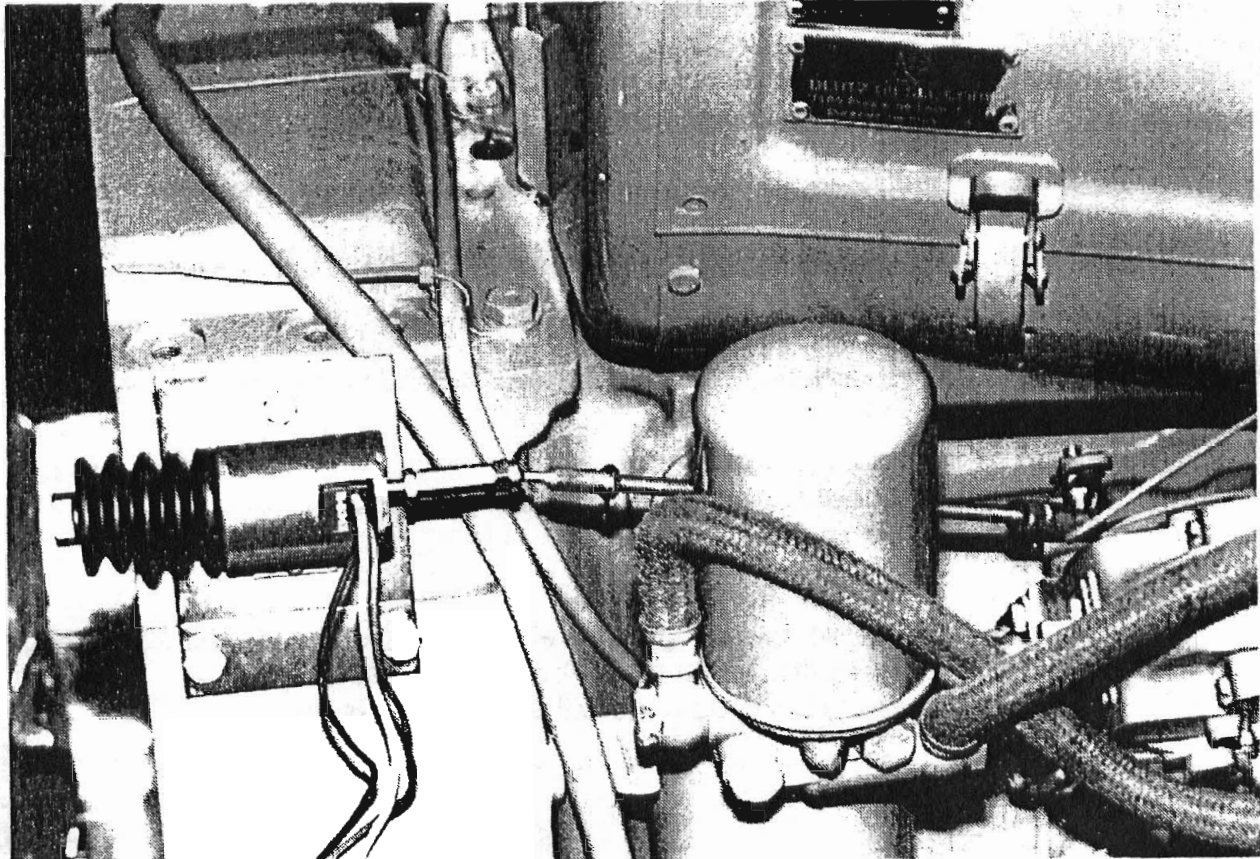

Mounting Instructions for Deutz 912 Series Shutdown Kits

*The only engine modification required is the removal of the torsion spring from the fuel shutoff lever.

1. Remove the fuel shutoff lever and torsion spring from the fuel pump.
2. Set up linkage rod assembly by attaching $\frac{1}{4}$ - 28 jam nut (7) and right angle ball joint (10) to the threaded rod (2).

NOTE:

3 & 4 cylinder units require only one rod as supplied (a 7-3/8" rod for 3 cylinder, and a 10 3/4" rod for 4 cylinder).

3. Attach right angle ball joint and rod (assembly from step 2 above) to fuel shutoff lever by installing in the bottom hole as indicated and securing with washer (5) and nut (7). Reattach fuel lever to fuel pump *minus* the torsion spring.
4. Install return spring (3) and attach protective boot (4) to the solenoid assembly.
5. Attach solenoid to mounting bracket (1) utilizing bolts (8) and nuts (6) and washers (5).
6. Remove top two bolts from engine bell housing which hold the inspection cover in place. Mount the bracket and solenoid assembly to engine housing utilizing bolts removed.
7. Attach $\frac{1}{4}$ -28 jam nut (7) and straight ball joint (11) to open end of rod assembly.
8. Attach $\frac{1}{4}$ -28 jam nut (7) and $\frac{1}{4}$ -28 hex spacer (9) to solenoid plunger rod.
9. Complete linkage assembly by connecting straight ball joint (11) to hex spacer (9).
10. Adjust linkage as necessary to obtain proper solenoid stroke and tighten all jam nuts. Plunger should move freely throughout the complete stroke and be allowed to "bottom" at the internal stop of a solenoid.

NOTE:

If improperly adjusted, the plunger will release when shifted to the "Holding" mode of operation. If plunger releases, readjustment of linkage is required. No damage will occur to the solenoid.

11. Perform electrical installation by utilizing the system configuration below. If your system is different than presented, please contact the factory for assistance in determining proper system wiring.

Solenoid Lead Identification:

- WHITE: lead is PULL COIL
- RED: lead is HOLD COIL
- BLACK: lead is GROUND (common)

Connect as indicated:

CAUTION: Coils that burn out due to improper electrical hookup are not covered by factory warranty.

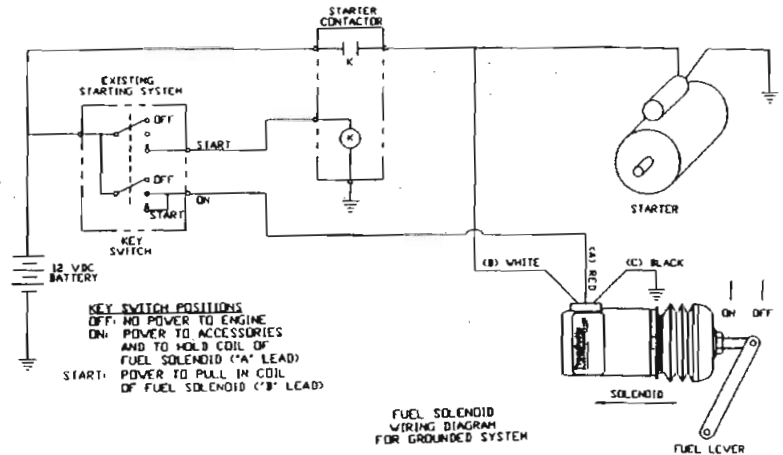

12. Verify wiring, stroke, and tightness of all connections. Operate engine and readjust as necessary.

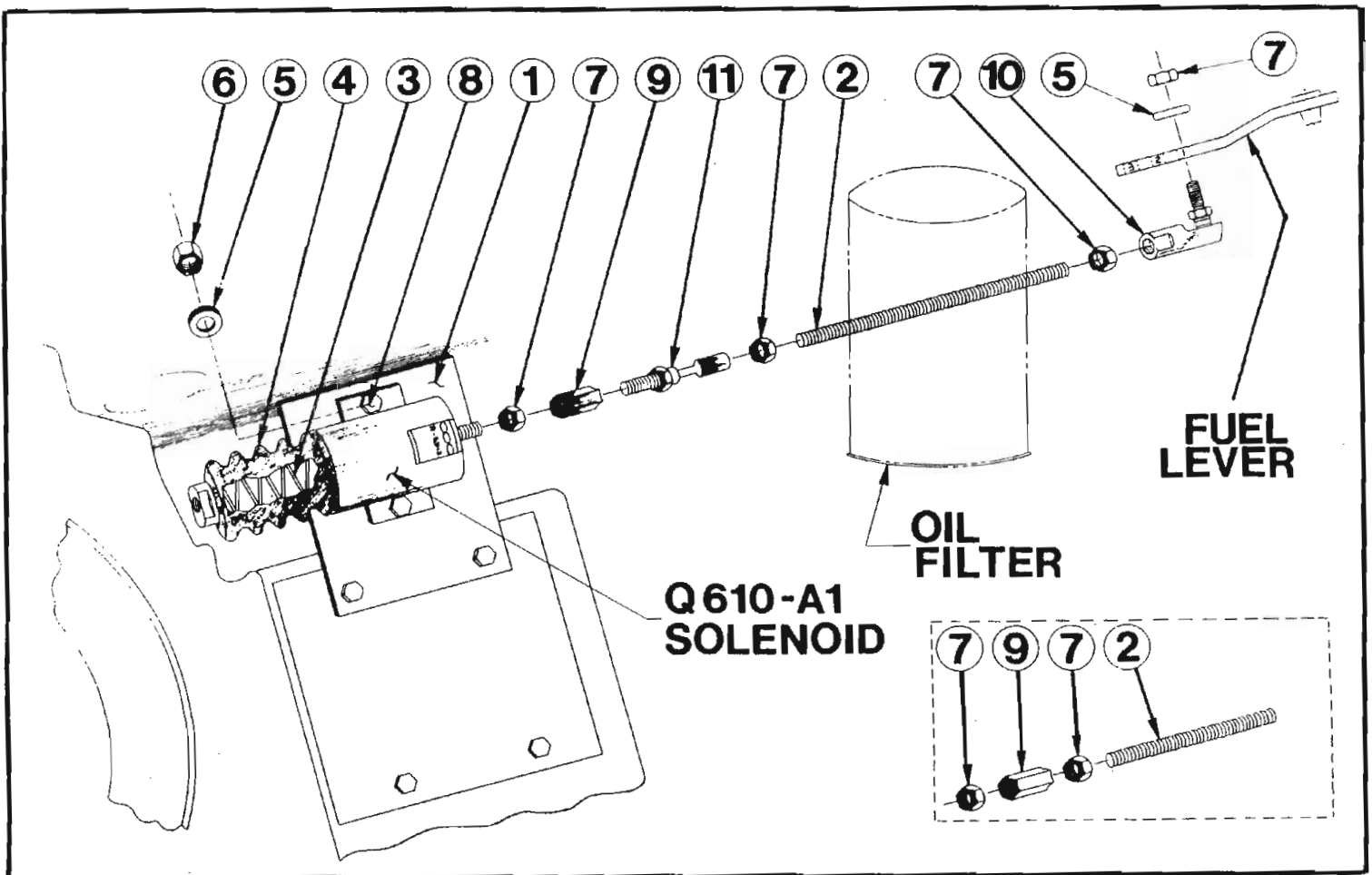

Linkage Kit Bill of Material

| Item # | Part # | Description | Qty. |
|--------|--------|-------------------------------|------|
| 1 | EO6250 | Mounting Plate | 1 |
| 2 A * | EO6251 | 3 cyl. Connecting rod 7-3/8" | 1 |
| B | EO6277 | 4 cyl. Connecting rod 10-3/4" | 1 |
| 3 | FO9514 | Return Spring | 1 |
| 4 | EO5871 | Boot | 1 |
| 5 | H10173 | 1/4 washer | 3 |
| 6 | H10187 | 1/4 - 20 Hex Nut | 2 |
| 7 | H10194 | 1/4 - 28 Hex Jam Nut | 4 |
| 8 | H10200 | 1/4 - 20 x 3/4 Hex Hd Screw | 2 |
| 9 | H10375 | 1/4 - 28 Hex Spacer | 1 |
| 10 | H10376 | Ball Joint R-107 | 1 |
| 11 | 10377 | Ball Joint PR-107 | 1 |

* 3 & 4 cylinder kits come with either item 2A or 2B as indicated.

5 & 6 cylinder kits require the use of two rods coupled together in order to achieve necessary length. The second rod and coupling hardware is automatically included with 5 & 6 cylinder kits (packaged separately as EO6279 Modification Kit).

Modification Kit Bill of Material

| Item # | Part # | Description | Qty. |
|--------|--------|-----------------------|------|
| 2 | EO6251 | Connecting rod 7-3/8" | 1 |
| 7 | H10194 | 1/4 - 28 Hex Jam Nut | 2 |
| 9 | H10375 | 1/4 - 28 Hex Spacer | 1 |

Use of this kit in conjunction with the 3 cylinder kit will provide the 5 cylinder package.
Use of this kit in conjunction with the 4 cylinder kit will provide the 6 cylinder package.

See illustration for assembly.

Order by part number - Specify Voltage

| Part Number | Description |
|-------------------------------------|-------------------------------|
| *Q610-A1V* WITH EO6295 KIT | Fits Deutz F3L912, 3 cylinder |
| *Q610-A1V* WITH EO6297 KIT | Fits Deutz F4L912, 4 cylinder |
| *Q610-A1V* WITH EO6295 & EO6279 KIT | Fits Deutz F5L912, 5 cylinder |
| *Q610-A1V* WITH EO6297 & EO6279 KIT | Fits Deutz F6L912, 6 cylinder |